

Cribb Floorplan

Second Floor

Clemson Memorial Stadium



No rooms on first floor

Cribb Floorplan

Third Floor

Clemson Memorial Stadium



Cribb Floorplan

Fourth Floor

Clemson Memorial Stadium

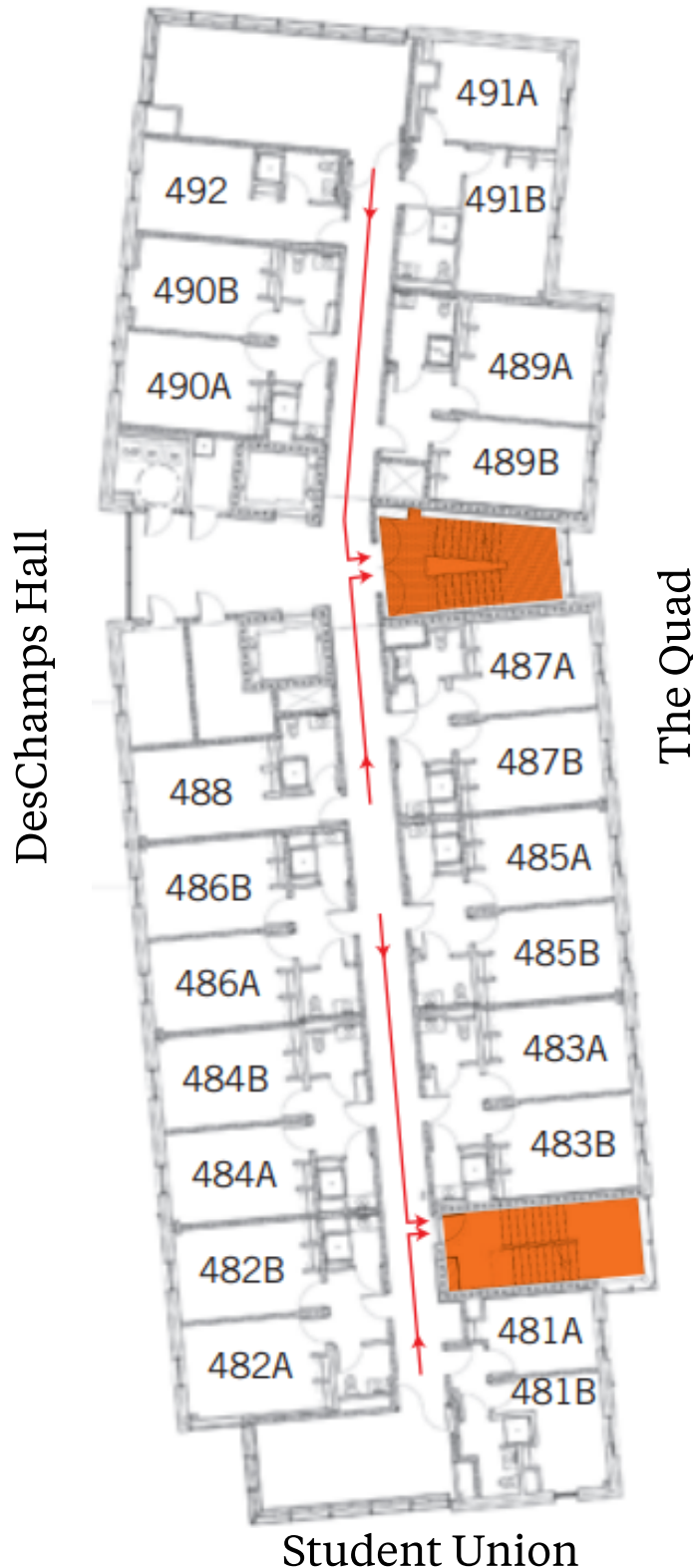

Cribb Floorplan

Fifth Floor

Clemson Memorial Stadium



Student Union

Cribb Floorplan

Sixth Floor

Clemson Memorial Stadium

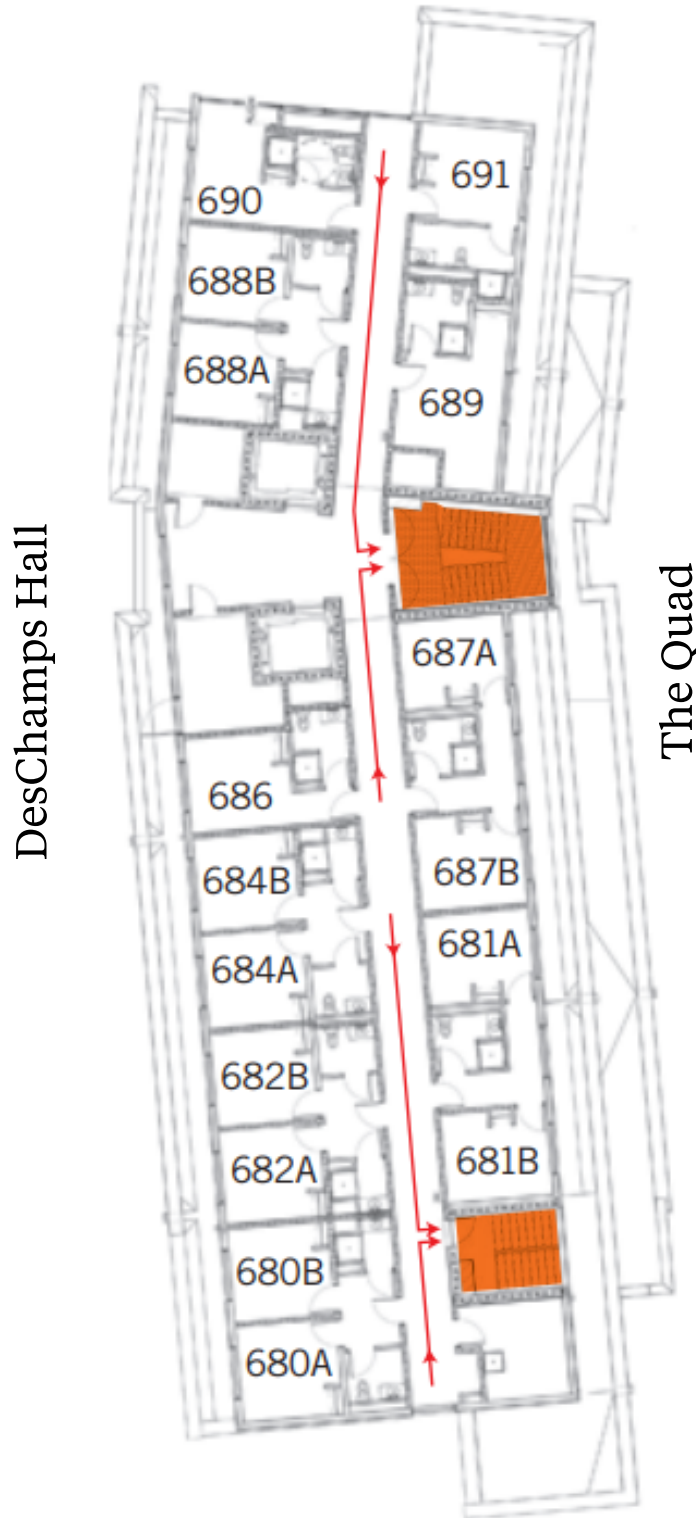

Student Union

Cribb Floorplan



Cribb Hall Quick Facts

- Room Size: 15' x 11'
- Furniture
 - Two XL twin beds (38" x 80" inside and 38" x 86" outside)
 - Two individual desks (30"W x 24"L x 30"H) and chairs
 - Two closets (63" from floor to shelf, average 30" wide)Two chest of drawers (30"W x 24"D x 30"H)
 - Window (38.5" x 70.5")
 - Venetian blinds
- Wall Color: Beige
- Carpeted floors
- Suite Style Bathroom
- Laundry: Floors 3, 4 and 5
- Kitchen: Great Hall Kitchen (Floor 1) and Floor 2
- All residence halls have AC
- Elevator from first to sixth floor